

GDRC系列中心钻

GDRC-Solid Carbide Center Drill -A

A&B 型可选。

Both A And B Type is available.



A型中心钻

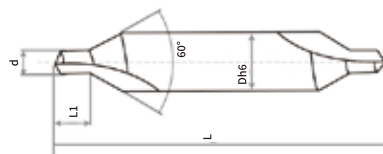

ITEM CODE	d	L1	Dh6	L
GDRCA-0100	Φ1.0	1.3	Φ3	50
GDRCA-0130	Φ1.3	1.6	Φ3	50
GDRCA-0160	Φ1.6	2	Φ4	50
GDRCA-0200	Φ2.0	2.5	Φ5	50
GDRCA-0250	Φ2.5	3.1	Φ6	50
GDRCA-0320	Φ3.2	3.9	Φ8	60
GDRCA-0400	Φ4.0	5	Φ10	75
GDRCA-0500	Φ5.0	6.3	Φ12	75
GDRCA-0630	Φ6.3	8	Φ16	75



B型带护锥中心钻

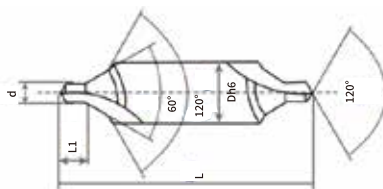

ITEM CODE	d	L1	Dh6	L
GDRCB-0100	Φ1.0	1.3	Φ3	50
GDRCB-0130	Φ1.3	1.6	Φ3	50
GDRCB-0160	Φ1.6	2	Φ4	50
GDRCB-0200	Φ2.0	2.5	Φ5	50
GDRCB-0250	Φ2.5	3.1	Φ6	50
GDRCB-0320	Φ3.2	3.9	Φ8	60
GDRCB-0400	Φ4.0	5	Φ10	75
GDRCB-0500	Φ5.0	6.3	Φ12	75
GDRCB-0630	Φ6.3	8	Φ16	75