

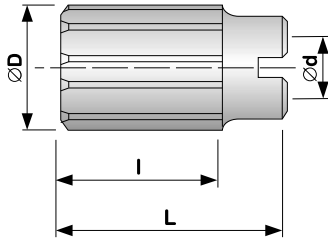

РАЗВЕРТКИ НАСАДНЫЕ С ПРЯМЫМИ КАНАВКАМИ
ROZWIERTAKI NASADZANE O OSTRZACH PROSTYCH
FELFÜZHETŐ DÖRZSÁRAK, EGYENES FOGAKKAL

ČSN 221447

DIN 219

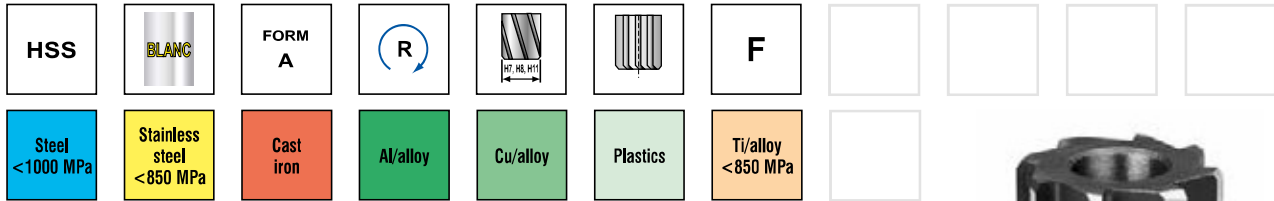

Номер для заказа Kod výroby Rendelési szám	ØD mm	L mm	l mm	Ød mm			Code 221447
B47025XF000S	25	45	32	13	10	0,090	25X
B47026XF000S	26	45	32	13	10	0,100	26X
B47027XF000S	27	45	32	13	10	0,110	27X
B47028XF000S	28	45	32	13	10	0,120	28X
B47029XF000S	29	45	32	13	10	0,130	29X
B47030XF000S	30	45	32	13	10	0,140	30X
B47031XF000S	31	50	36	16	10	0,160	31X
B47032XF000S	32	50	36	16	10	0,170	32X
B47034XF000S	34	50	36	16	10	0,185	34X
B47035XF000S	35	50	36	16	10	0,200	35X
B47036XF000S	36	56	40	19	10	0,230	36X
B47038XF000S	38	56	40	19	10	0,260	38X
B47040XF000S	40	56	40	19	10	0,290	40X
B47042XF000S	42	56	40	19	12	0,330	42X
B47044XF000S	44	63	45	22	12	0,435	44X
B47045XF000S	45	63	45	22	12	0,455	45X
B47046XF000S	46	63	45	22	12	0,475	46X
B47048XF000S	48	63	45	22	12	0,495	48X
B47050XF000S	50	63	45	22	12	0,515	50X
B47052XF000S	52	71	50	27	12	0,640	52X
B47055XF000S	55	71	50	27	12	0,760	55X
B47058XF000S	58	71	50	27	12	0,830	58X
B47060XF000S	60	71	50	27	14	0,900	60X
B47062XF000S	62	80	56	32	14	0,970	62X
B47063XF000S	63	80	56	32	14	1,100	63X
B47065XF000S	65	80	56	32	14	1,160	65X
B47068XF000S	68	80	56	32	14	1,340	68X
B47070XF000S	70	80	56	32	14	1,500	70X
B47072XF000S	72	90	63	40	14	1,670	72X
B47075XF000S	75	90	63	40	14	1,810	75X
B47078XF000S	78	90	63	40	14	2,150	78X
B47080XF000S	80	90	63	40	14	2,240	80X
B47082XF000S	82	90	63	40	14	2,450	82X
B47085XF000S	85	90	63	40	14	2,590	85X
B47088XF000S	88	100	71	50	16	3,100	88X
B47090XF000S	90	100	71	50	16	3,170	90X
B47092XF000S	92	100	71	50	16	3,280	92X
B47095XF000S	95	100	71	50	16	3,430	95X
B47098XF000S	98	100	71	50	16	4,150	98X
B47100XF000S	100	100	71	50	16	4,170	100X

Примечание / Uwagi / Megjegyzés: для крепления используются оправки ČSN 241210 (DIN 217) / do mocowania służą trzpienie ČSN 241210 (DIN 217) /
ČSN 241210 (DIN 217) tartó a felfűzéshez
X = посадка развертки (7 = H7; 8 = H8; 1 = H11) / X = tolerancia rozwiertaka (7 = H7; 8 = H8; 1 = H11) /
X = illesztő dörzsár (7 = H7; 8 = H8; 1 = H11)

